



# **Smithfield Riverside Redevelopment Programme and Transforming Movement and Public Spaces in Shrewsbury**

## **Appendix A MAPS & DRAWINGS**



# LOCATIONS OF SHREWSBURY'S LEVELLING UP BID

- Key Connection
- Project 1: Smithfield Riverside Regeneration Programme
- Project 2: Transforming Movement and Place, location of the interventions

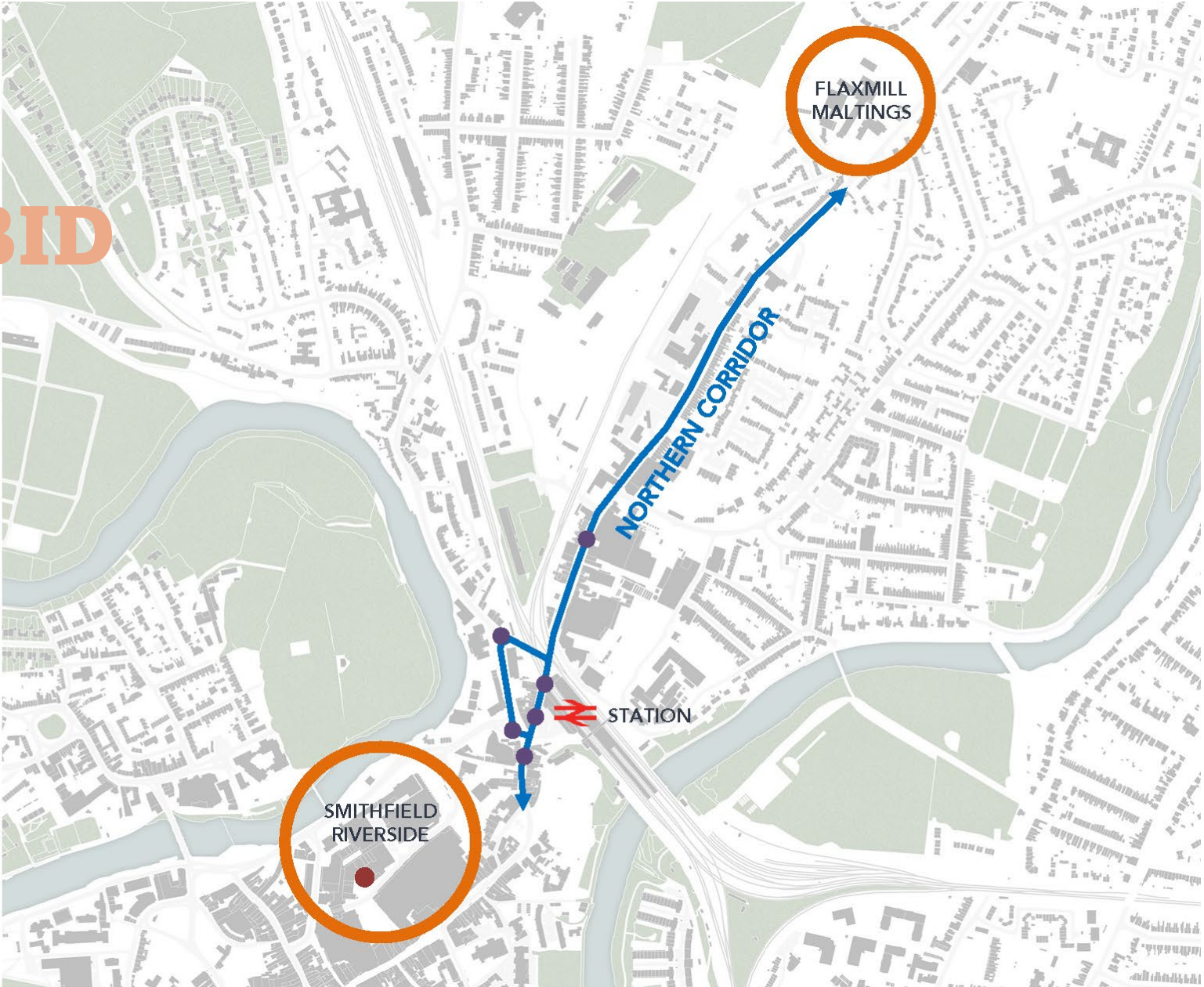





# **Smithfield Riverside Redevelopment Programme and Transforming Movement and Public Spaces in Shrewsbury**

## **Project 1: Smithfield Riverside Regeneration Programme – maps and drawings**



# Project 1: Smithfield Riverside Redevelopment Programme

## Masterplan Vision (Phase 1)

- ..... LUF Zone A
- ..... LUF Zone B

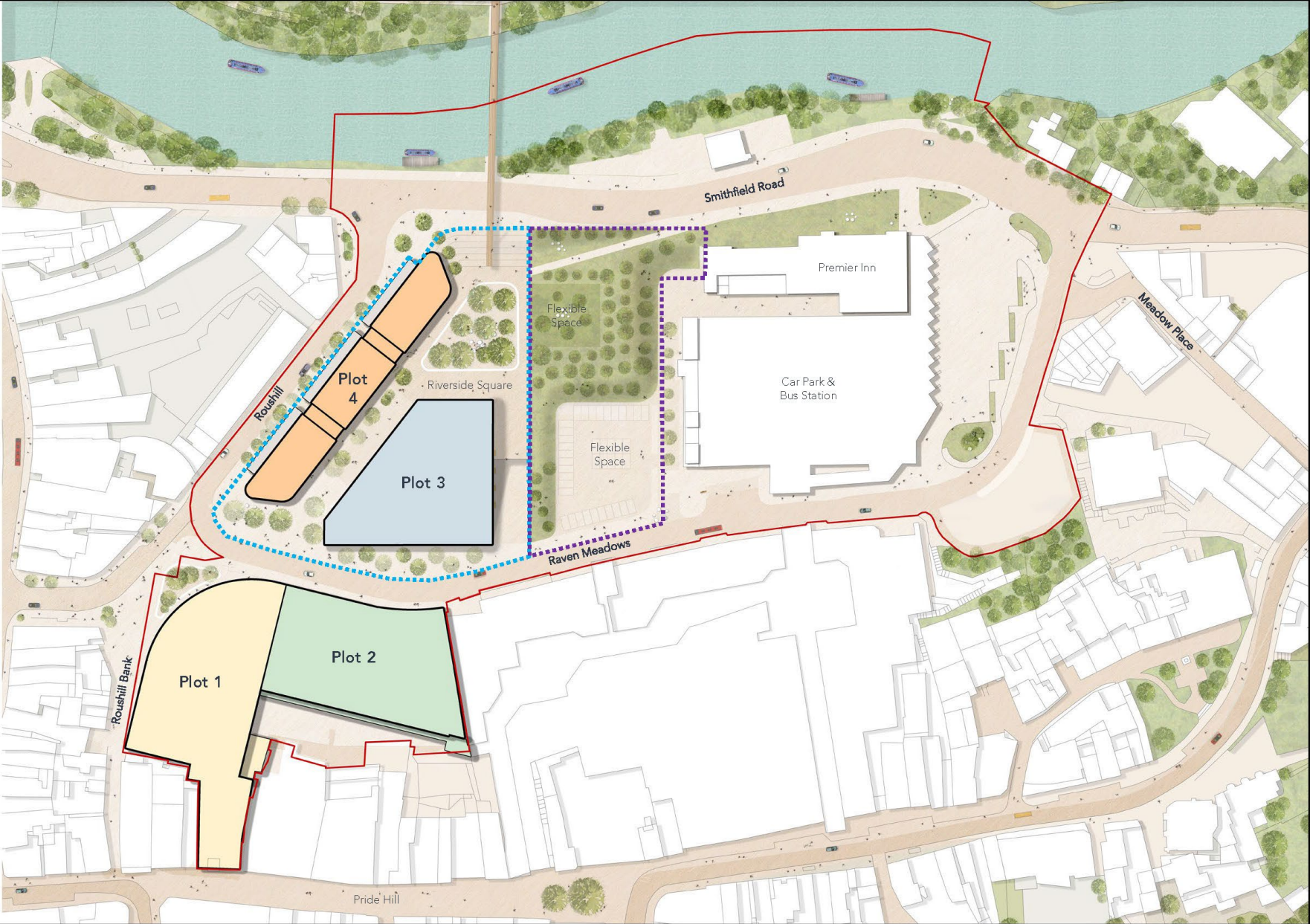



**DELIVERY OF PROJECT 1:**

# **- SMITHFIELD RIVERSIDE**



**FACILITATED BY LUF2 INVESTMENT**



**Current Drone Images of the Smithfield Riverside Site**





**Current Drone Images of the Smithfield Riverside Site showing River Severn frontage**





**Current Drone Images of the Smithfield Riverside Site and proximity to Shrewsbury Railway Station and onto the Northern Corridor (Station showing on left hand side)**





# Current Drone Images of the Smithfield Riverside Site







**Smithfield Riverside Redevelopment  
Programme and Transforming Movement  
and Public Spaces in Shrewsbury**

**Project 2: Transforming Movement  
and Public Spaces  
– maps and drawings**



## Project 2: Transforming Movement and Public Spaces

### Public Realm Improvements

- Resurfacing footways to provide consistent material palette
- Provision of wayfinding signage
- Widening footways to facilitate improved pedestrian connections
- Lighting and public art interventions

### Traffic Management

- Traffic management improvements to introduce two-way cycle infrastructure, reduced vehicle speeds, bus only provision and changes in direction of the traffic.
- 2.3 km of enhanced walking routes and cycleways across the Station and Northern Corridor areas.

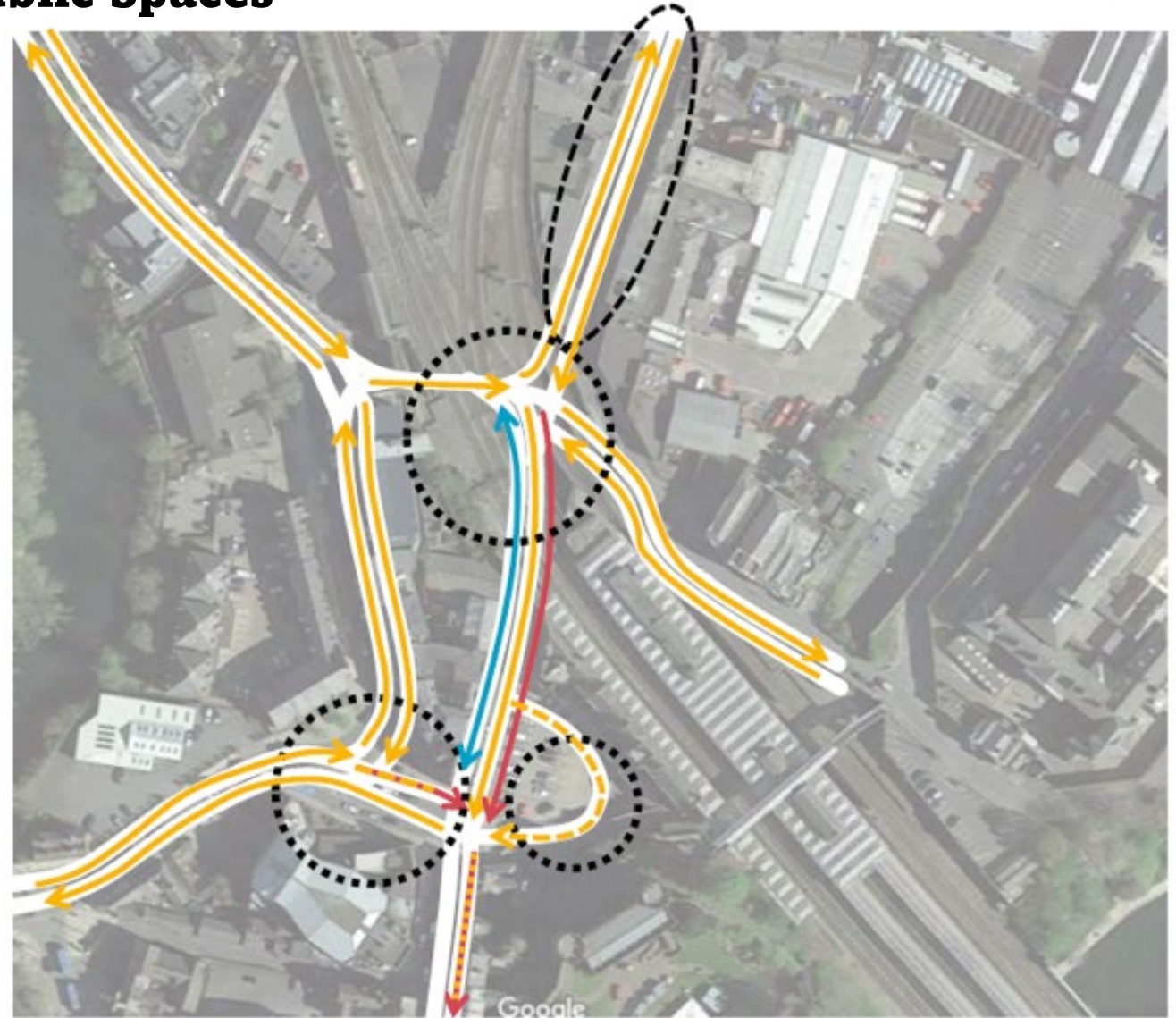

Imagery (C) 2011 Google, Imagery (C) 2022 Bluesky, Infoterra Ltd & COWI A/A, CNES/Airbus, Getmapping plc, Infoterra Ltd & Bluesky, Maxar Technologies, Map Data (C) 2022



Public Realm Improvements



General Traffic



Cycles



Buses



Permit Holders & Access/Serviceing



# Current Drone Images of the Station area and out towards the Northern Corridor





**Current Drone Images of the Station area showing gyratory area, Railway Bridges (Project 2) and along Smithfield Road and the Former Riverside Shopping Centre (Project 1) – illustrating proximity of the two projects along ‘The Big Connection’**

